



A Legacy of Innovation Spanning 101 Years

In 1920, Quincy established its reputation for engineered solutions and provides uncompromising reliability for demanding applications. Its flagship products, QR-25 and QSI have proven to be reliable choices for users in some of the toughest conditions like mining, drilling, concrete production and shipbuilding. Nearly 40 percent of rotary sales are considered custom orders with one-of-a-kind configurations ranging from electrical specialties to freeze-protection options. The Quincy brand is synonymous with quality, delivering "Performance You Demand. Reliability You Trust."





about global

Global Furniture Group originated in 1966, when the company was founded with the vision of manufacturing well-made office furniture at affordable prices. That promise continues today through a network of vertically integrated suppliers, manufacturers and distributors who bring our products to market around the world.

Global offers a comprehensive portfolio of solutions that are designed and engineered to meet the changing needs of the Workplace, Education and Healthcare markets. Our success over the past half-century owes much to our diverse team, who take pride in creating quality products and providing the highest level of service to our clients.

Above all, Global is a trusted partner. We are committed to our customers' needs by working together to develop lasting and valued solutions.



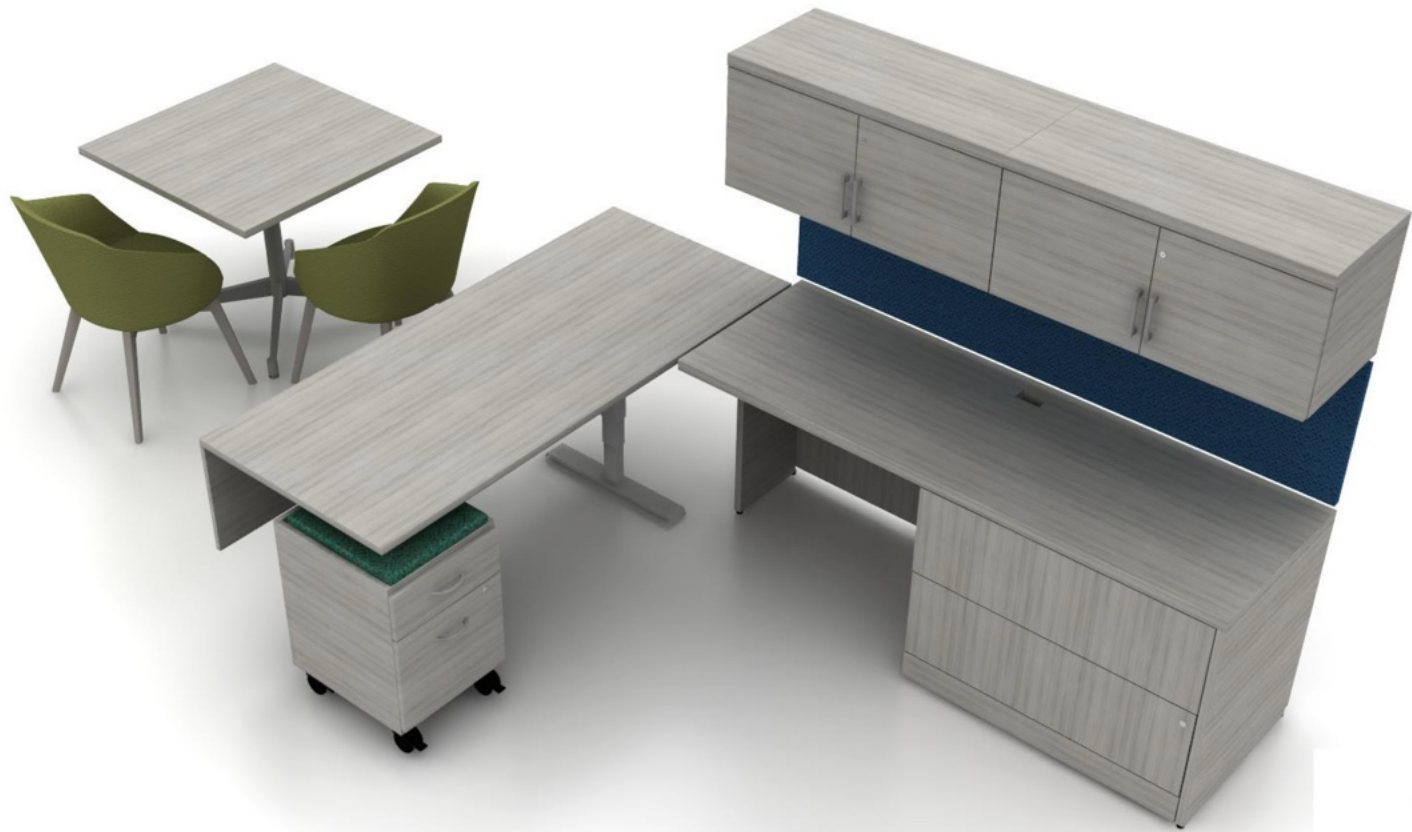





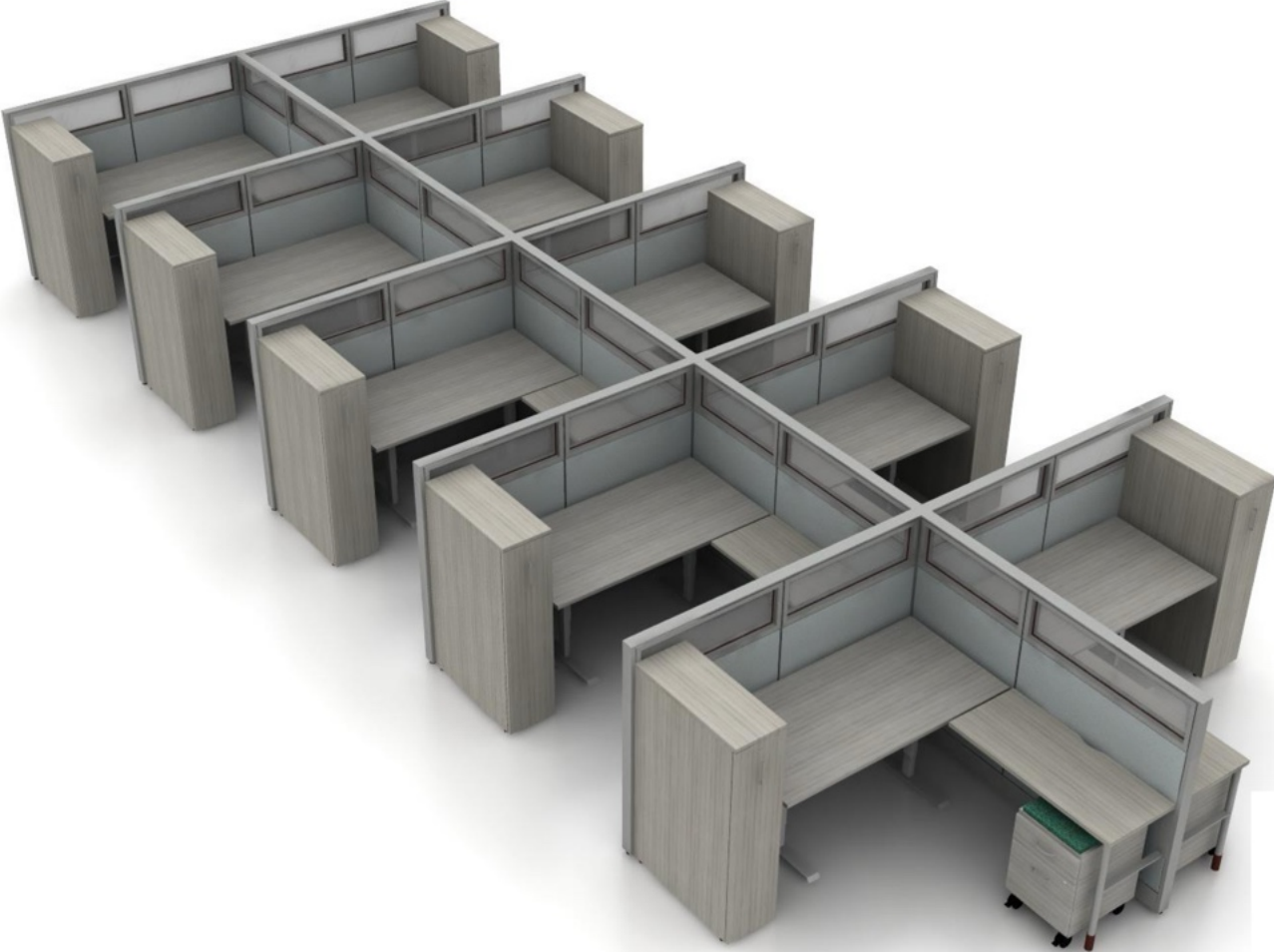







wind



Tables



Square table. MDF top shown.



Square table. Laminate top shown.



Round table. MDF top shown. Also available with laminate top.

Laminates



Absolute Maple
(AMC)



Asian Night
(ASN)



Aurore Cherry
(ARC)



Aurore Honey
(AHN)



Black
(BLK)



Brushed Cobalt
(BRC)



Clear Maple
(CMB)



Dark Espresso
(DES)



Designer White
(DWT)



Hayden Grey
(HGT)



Noce Blondo
(NBL)



Noce Grigio
(NGL)



Noce Leggero
(NLL)



Noce Medio
(NML)



Quartered Mahogany
(QTM)



Storm Grey
(DGG)



Tiger Fruitwood
(TFW)



Tiger Walnut
(TWL)

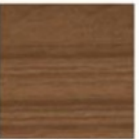

Walnut Heights
(WHH)



White Chocolate
(WHC)



Willow Grey
(WGT)



Winter Cherry
(WIC)



Sit, stand and move



Encourages continuous body movement



Revitalizes blood flow, boosts energy levels,
reduces body stressors and fatigue



Adapts to a range of body types and tasks



Mechanisms



Weight sensing synchro-tiler



Synchro-tiler with back angle adjustment



Multi-tiler



Tiler



Task (swivel only)

Seat Options



Standard 20" w



Petite 18" w

Petite seat option

Arm options



Standard height/width adjustable arms with sliding armcaps



Task and fixed arms available in black or optional Fog (shown)



Optional fixed arms available for management and conference applications



Polished Aluminum fixed arm available

Base options



Standard Black



Optional Polished Aluminum



Optional Fog

Guest chair frame finishes



Standard Black



Optional Charcoal



Optional Fog



Optional Tungsten



Optional Chrome

Options



Frame available in black or optional Fog (shown)



Optional Black lumbar pad provides 1" of adjustment



Global Drift Side Guest Chairs



Features



Lounge seat cushion is molded with double density cold-cured polyurethane that provides a soft and luxurious sit



Fully upholstered stool features a steel frame and weighted base to ensure stool always stays upright

Finishes



Swivel wood base is available in all standard wood finishes



Four-legged wood fixed base is available in all standard wood finishes



Metal four-prong swivel base is available in Polished Chrome

Tables



Available with Polished Chrome or wood bases



Fixed table tops are available in three sizes and three shapes (round top shown)



Evolve System

Designed for the way people work, Evolve meets the challenges of today's rapidly changing workplace. Featuring simple, crisp and clean aesthetics, Evolve's adaptability provides limitless planning possibilities for a greater return on your investment.

Evolve is furniture that fits your work style and your budget.

Furniture for today, flexibility for tomorrow. Evolve's Light Panel System creates a sense of openness without sacrificing individual space or storage capabilities. Shared workstations promote collaboration and reduce the overall footprint.

Create privacy anywhere.

Evolve's panels are stackable in 6", 12" & 24" modules from 30 inches up to 25 feet and allow private offices to be constructed without relying on existing walls. Interchangeable fabric, laminate and glass finish options can be used to achieve varying privacy, acoustical and aesthetic needs without needing to disassemble panels onsite.

Promote collaboration, while retaining a sense of individual space.

The Evolve Panel System can be stacked and switched for maximum flexibility and effortless reconfiguration. Panels also integrate plug and play connectivity at the worksurface and offer proven wire management to meet your power and data needs. Cost-effective planning is made easy with Evolve's range of ergonomic worksurfaces and practical storage options.



ACE OFFICE FURNITURE

HOUSTON

Example of Evolve Products



Samples of Paint & Fabrics sent per request

PAINT:

Evolve and Power Beam Paint Colors:

For application to trim, steel components, PVC, vertical and horizontal members.



BZD
Blizzard

CHR
Charcoal

BLK
Black

SIL
Silver



SDT
Stone Dust

TPE
Taupe

TUN*
Tungsten

NEV
Nevada



DWT
White

STL**
Steel

Aurora

100% Polyester, 80% minimum Post-Consumer Recycled Polyester

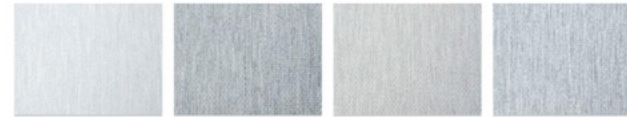

AU20
Cloud

AU21
Seal

AU22
Fog

AU23
Pewter



AU24
Granite

AU25
Oat

AU26
Coconut

AU27
Latte



AU28
Lake

AU29
Frost



AN40
Birch

AN41
Green Apple

AN42
Lapis

AN43
Straw



AN44
Wolf

AN45
Goose

AN46
Angora

AN47
Cumin



AN48
Amethyst

AN49
Coral

AN50
Turquoise

AN51
Onyx

Laminates



Absolute Maple
(AMC)



Asian Night
(ANL)



Aurore Cherry
(ARC)



Aurore Honey
(AHN)



Black
(BLK)



Brushed Cobalt
(BRC)



Clear Maple
(CMB)



Dark Espresso
(DES)



Designer White
(DWT)



Hayden Grey
(HGT)



Noce Blonde
(NBL)



Noce Grigio
(NGL)



Noce Leggero
(NLL)



Noce Medio
(NML)



Quartered Mahogany
(QTM)



Storm Grey
(SGG)



Tiger Fruitwood
(TFW)



Tiger Walnut
(TWL)



Walnut Heights
(WHH)



White Chocolate
(WHC)



Willow Grey
(WGT)



Winter Cherry
(WIC)



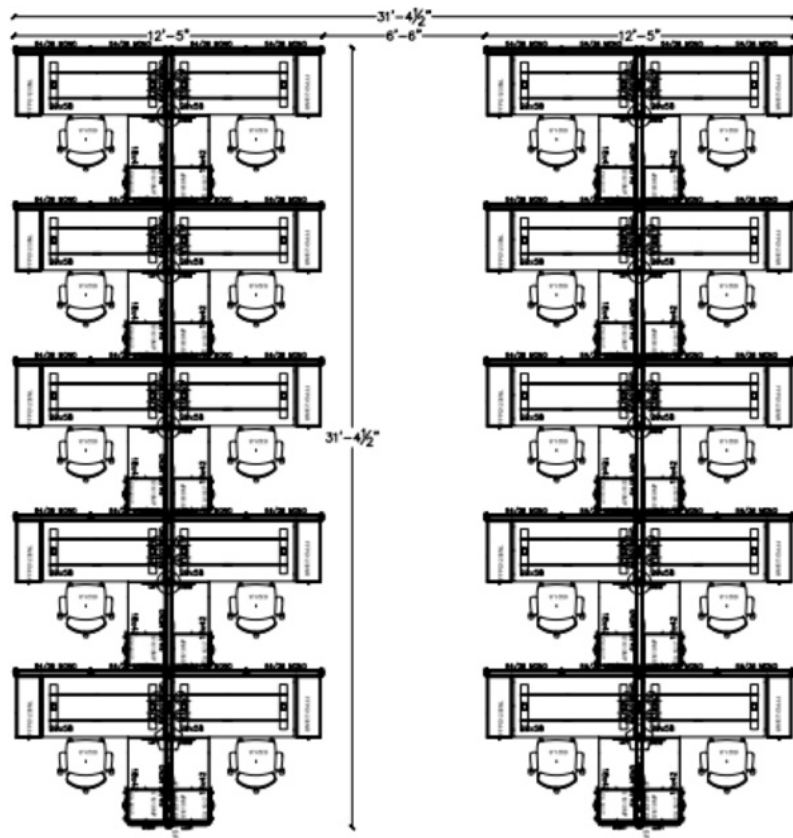

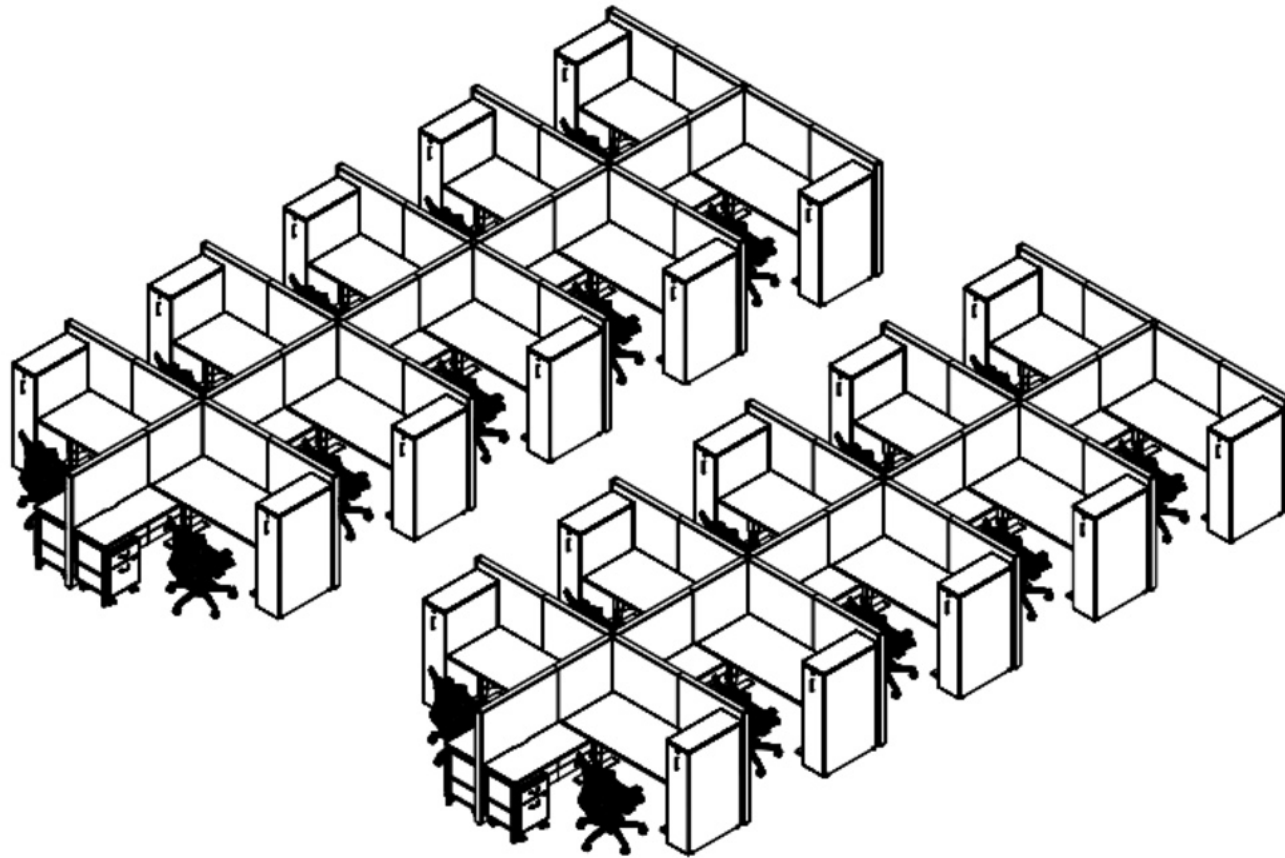



ZIRA CONFERENCE TABLE EXAMPLE



Global Accord™ Upholstered High Back Tilter (2670-4)



This award-winning series features classic styling with a finely detailed polished aluminum arm.

- The sling style back is upholstered with rolled and pleated details, and is available in an array of fabrics, vinyl's or fine Italian leathers.
- Clean simple lines make Global Accord the perfect choice for meeting rooms, boardrooms and private offices.
- Global Accord Mesh is available in a wide selection of designer colors.
- The breathable mesh back promotes airflow and comfort while gently supporting the natural curve of the spine to reduce fatigue.
- Durable urethane armcaps are soft and warm to the touch.
- Tilt-tension adjustment and multiple position tilt-lock control.
- Designed by Zooney Chu.

Dimensions: W25 x D25 x H44 IN.

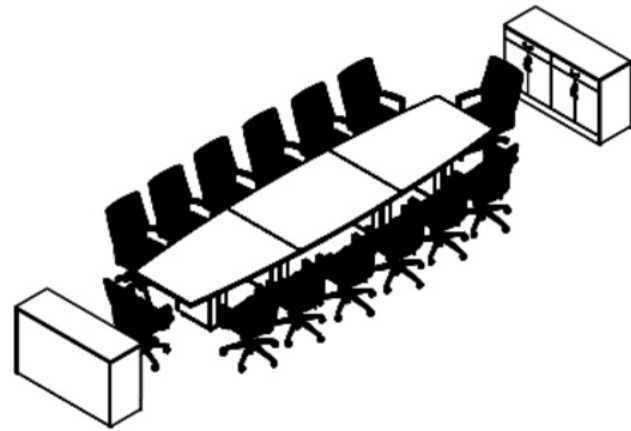
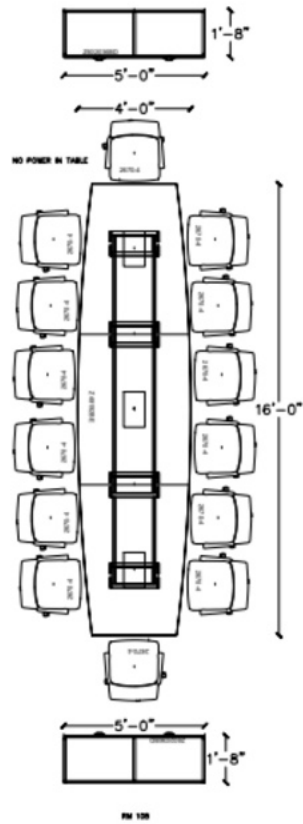

Warranty

Global Warranty Information

A History of Success

Founded in Canada in 1966, The Global Group is one of the largest manufacturers and marketers of quality business furniture in the world. Our facilities include more than 40 just-in-time manufacturing and product assembly plants, plus offices, showrooms and distribution facilities.

Customer service is the cornerstone of our continued success and the reason why the Global choice is often the first choice for office furniture solutions by clients the world over.

Ergonomics

Global manufactures an extensive selection of office furniture in the areas of seating, files and storage, caseworks, panels and computer accessories. The people at Global are proud to bring you office furniture manufactured with ergonomic features integrated into every product in order to help build a healthy, comfortable and productive work environment.

ISO 9000

At Global, we continue to set the highest quality product standards. Registration to ISO 9000, the international standard for quality systems is just one example of our longstanding promise to manufacture office furniture that is built to work better and last longer.

Research and Development

The Global Group is one of the very few business furniture companies worldwide to maintain an in-house testing laboratory. The testing laboratory and its support programs certify our components and finished products. Global certified office furniture products meet, and often exceed industry and government standards.

The Environment

At Global we're proud of our pledge to maintain a clean environment. We have long established environmental programs throughout our plants and offices to sustain our 'earth friendly' commitment. The people at Global take every opportunity to Reduce, Reuse and Recycle.

ISO 14001

At Global we're proud to say we're ISO 14001 registered. ISO 14001 is the benchmark international standard for the implementation and operation of an environmental management system. Certification requires a commitment to continuously improve practices that protect the environment.

Limited Lifetime Warranty

Global warrants that all commercial products are free from defects in material and workmanship, for the life of the product, to the original purchaser. Global will repair or replace, at Global's option, as the sole remedy for any defect covered by the warranty. For detailed conditions, refer to the current Global Price List.

This warranty covers the following product categories.

1. General Seating
2. Filing
3. Panels
4. Desks, Modular Furniture and Tables

LIMITED LIFETIME WARRANTY



DeMontrond
CONROE • HOUSTON • TEXAS CITY

 Centurion Pipeline L.P.



EQ
enQuest



HPO Global  HPO Global Resources Ventures Inc

ALFRED TALKE
Logistic Services

 **DLTRADING**



Davita
bringing quality to life™



SYNERGEN X

 Ervin Cable Construction, LLC

flnb First Liberty National Bank





